

Locks for T handles series 4000 RS1

Model 4010 RS1

Description

Mechanically Re-Programmable security lock with 90° rotation for professional applications



Technical specifications

- System: mechanically Re-Programmable with 7 million different keys
- Body material: brass
- Rotation: 90° clockwise
- Spring-loaded latch
- Brass latch

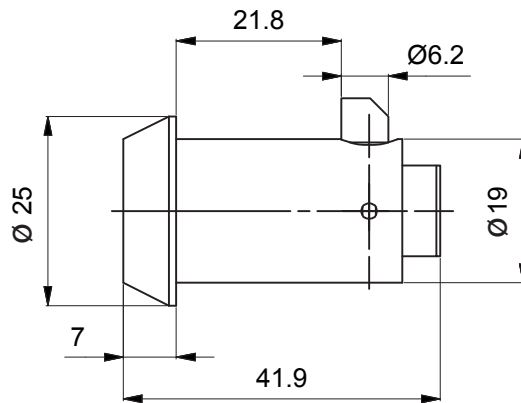

Resistant to:

- Bumping
- Picking
- Drilling

